

LOC 15238

97

VIEW ASPECT FROM CHURCH

PINJARRA - WILLIAMS ROAD

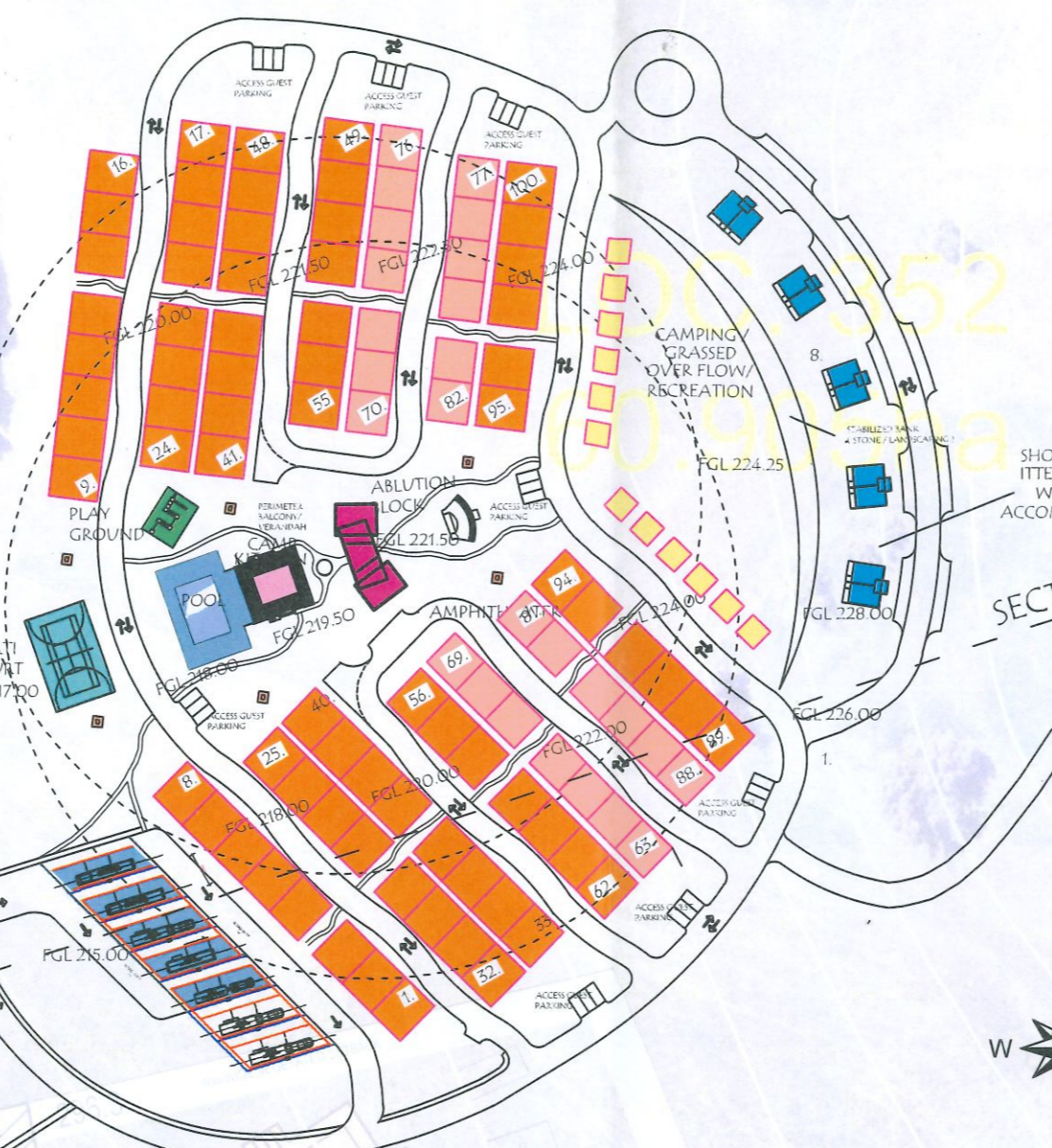
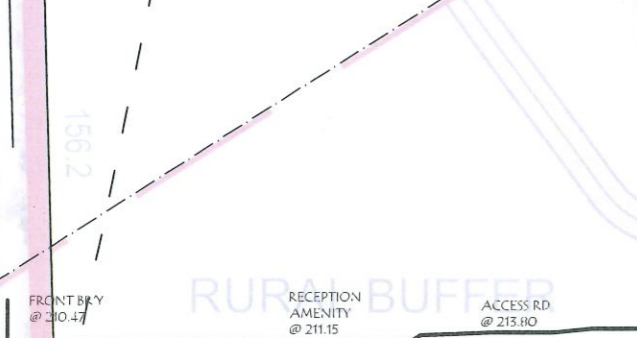
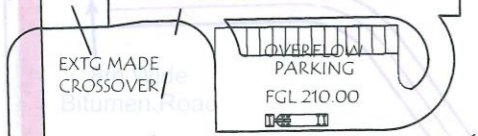
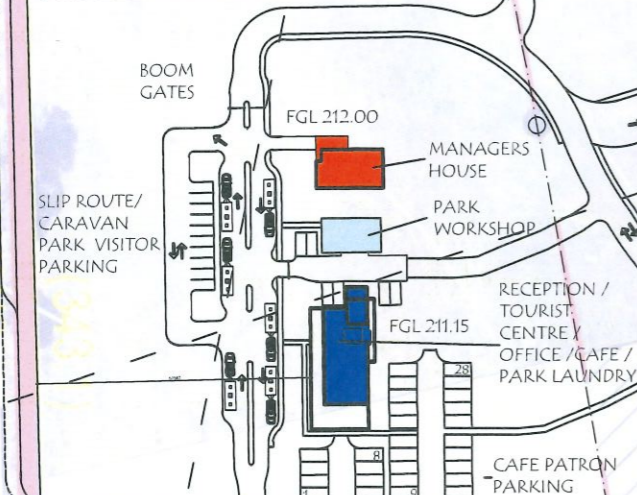

SECTION A-A

LEGEND - CARAVAN PARK

12x10 SITES	74	PLAYGROUND	(1)
10x10 SITES	26	ROAD NETWORK (ASPHALT)	-
6X6 CAMPING SITES	12	PATH NETWORK	-
DRIVE THRU SITES	5 (7)	ADMIN AMENITY (RECEPTION EX)	(1)
CABINS	6	SERVICE AMENITY (SHED/OTHER)	(1)
SHORT STAY DUPLEX'S	(8)	WELLNESS CENTER	(1)
MANAGERS RESIDENCE	0	RECREATION OPEN SPACE	-
ABLUTION AMENITY	(1)	OVER FLOW SITES	(32)
CAMP KITCH	(1)		
SHELTERS / BBQ	(3)		
TOTAL SITE No			123
EXC No IN ()			-

SECTION A-A

10.84ha



SHORT-STAY ITTENERANT WORKER ACCOMMODATION

(6 OFF) CABINS TOURIST

CABIN RD ACCESS @ 239.75
WELLNESS CTR @ 250.00
NGL @ 254.54

WORKER ACCOM @ 228.00

FRONT BRY @ 210.47

RECEPTION AMENITY @ 211.15

ACCESS RD @ 213.80

DRIVE THRU @ 215.00

SITE 01-32 @ 218.00

SITE 33-62 @ 220.00

SITE 63-88 @ 222.00

SITES 89-100 @ 224.00

DWG No 6725 - SK - 11 JOB No SCALE TYP REV	ISSUE DATE 27/06/23 PREV ISSUE 22/06/23	SHEET No A-01 1 of 1 SHEETS
SITE PLAN QUINDANNING TOUREST PARK WILLIAMS LOCATION 352 PINJARRA-WILLIAMS RD QUINDANNING FOR SHIRE WILLIAMS		
ADDRESS / POST: BRIGHTHOUSE CONSULTANTS P.O. BOX 1185 MANDURAH WA 6210 TEL: 0418915532 E-MAIL: consultant@bighthouse.com.au www.bighthouse.com.au		
PREPARED BY BRIGHTHOUSE CONSULTANTS - MANDURAH - WESTERN AUSTRALIA - TEL 0418 915 532 E-MAIL: CONSULTANT@BRIGHTHOUSE.COM.AU		